

PLAN LEGEND	
	EXISTING ROOFING SYSTEM TO BE REMOVED
	EXISTING TO REMAIN
N.I.C.	DENOTES "AREA OF NO WORK" (UNLESS OTHERWISE NOTED)
	KEYED DEMOLITION NOTATIONS
	EXISTING TO BE REMOVED
	CHANGED IN ELEVATION
(E)EX	EXISTING EXHAUST FAN
(E)RD	EXISTING ROOF DRAIN
(E)CU	EXISTING CONDENSING UNIT
(E)V	EXISTING VENT
(E)PP	EXISTING PIPE PORTAL
(E)ED	EXISTING ELECTRICAL DISCONNECT
(E)SC	EXISTING SCUPPER
HP	HIGH POINT
	EXISTING CONDUIT

DEMOLITION KEY NOTES:

- EXISTING ROOF SYSTEM TO BE REMOVED IN ITS ENTIRETY DOWN TO DECK.
- EXISTING PLUMBING VENTS TO REMAIN.
- REMOVE AND SALVAGE EXISTING EXHAUST FANS FOR REINSTALLATION. EXISTING CURB AND FLASHING TO BE REMOVED IN THEIR ENTIRETY.
- REMOVE AND SALVAGE EXISTING CONDENSING UNIT, REFRIGERANT LINES, CONDUIT, AND ELECTRICAL DISCONNECT.
- EXISTING PIPE PORTAL TO BE REMOVED AND PREPARED TO BE REPLACED.
- EXISTING SCUPPER, AND DOWNSPOUT TO BE REMOVED IN THEIR ENTIRETY.
- EXISTING CAPPED EXHAUST DUCTS TO BE REMOVED AND FILLED IN.
- REMOVE COUNTER FLASHING AND SEALANT AROUND THE PERIMETER WHERE EXPOSED, IN THEIR ENTIRETY.
- NOT USED.
- EXISTING LADDER TO REMAIN.
- EXISTING GUTTER AND DOWNSPOUTS TO DEMOLISHED. PREP AREA FOR REPLACEMENTS.
- EXISTING ROOF DRAIN TO BE REMOVED AND PREPARED FOR REPLACEMENT.
- EXISTING 8" TALL DUCT VENT WITH BRACING CABLES. VENT TO REMAIN, BRACING CABLES TO SALVAGED FOR RE-INSTALLATION.

ROOF CORE INFORMATION:

- CORE 2:
- METAL DECK
  - 1/4" GYPSUM BOARD
  - 4-1/2" TAPERED POLY-ISO INSULATION
  - 3/4" WOOD FIBER
  - MODIFIED BITUMEN MEMBRANE
  - TOTAL ASSEMBLY = 6"
- CORE 3:
- METAL DECK
  - 1/4" GYPSUM BOARD
  - 2-1/2" TAPERED POLY-ISO INSULATION
  - 3/4" WOOD FIBER
  - MODIFIED BITUMEN MEMBRANE
  - TOTAL ASSEMBLY = 4"

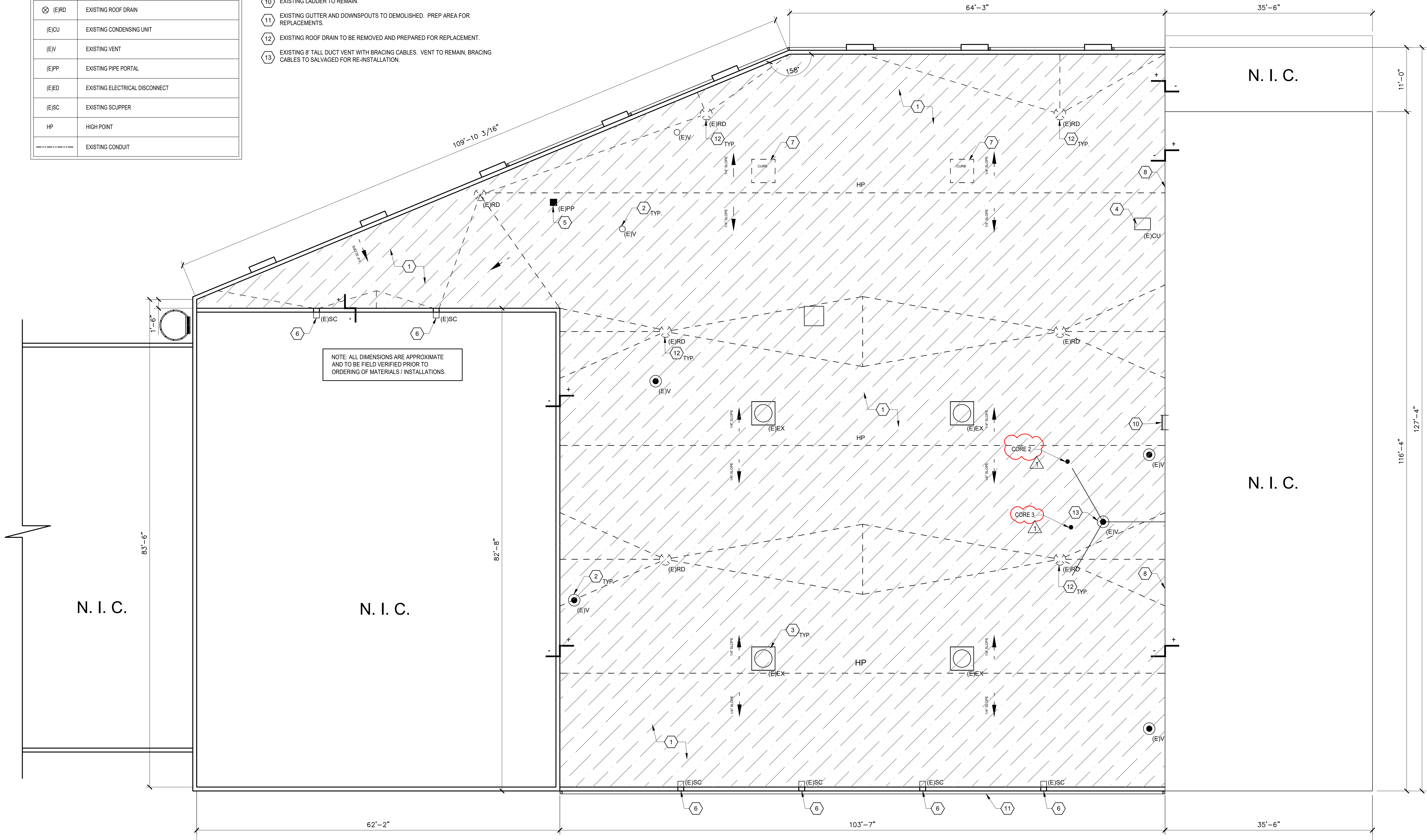

# SJM

SJM ARCHITECTURE, LLC  
954 KINDERKAMACK ROAD  
RIVER EDGE, NJ, 07661  
551.427.1487

STEPHEN J. MARTINEZ  
NJ AI 20890

No	Description	Date
	FOR BID	9/23/2022
1	ADDENDUM 1	1/30/2023

Project Number	2022.SM.005
Issue Date	9/23/2022
Drawn By	
Scale	AS NOTED
Drawing Title	

DEMOLITION ROOF PLAN

Drawing Number

## D100